

Getting Started—Parents' View Survey

Thank you for taking the time to complete our Parents' View Survey. Your views will contribute to the continual development of education and support we offer your child.

Please follow the step-by-step instructions to log on to the Parents' View Survey.

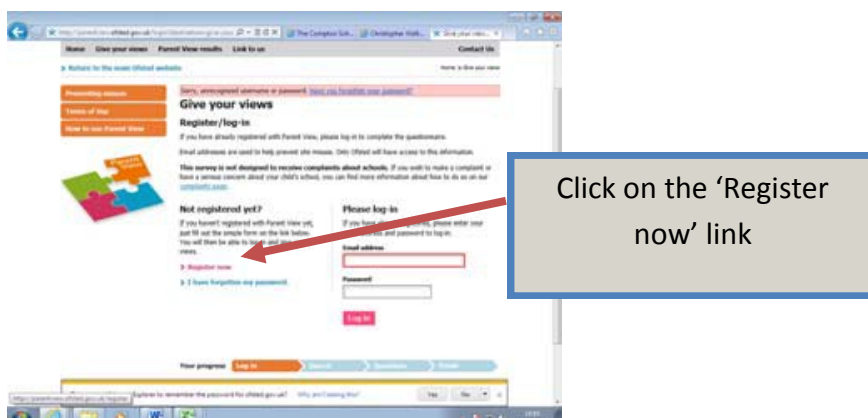
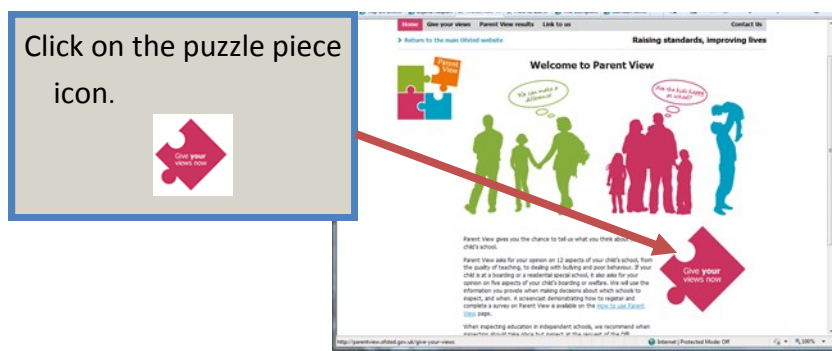
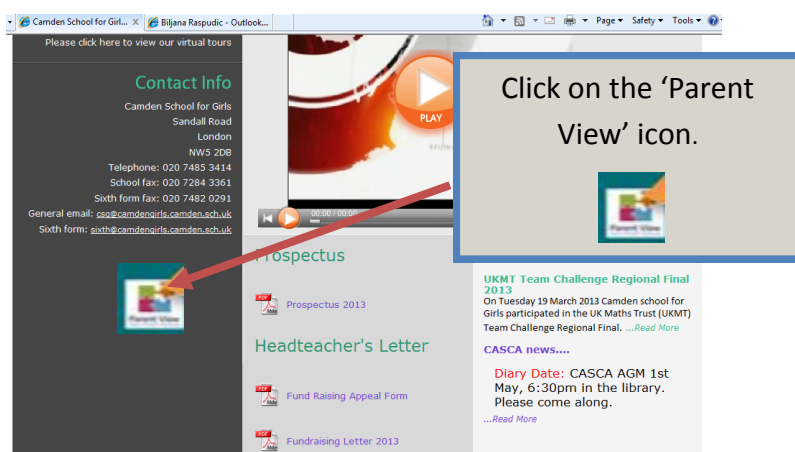

Complete the registration page.

* Please note you will need to access your own personal email account to complete the survey.

Home Give your views Parent View results Link to us Contact Us

Return to the main Ofsted website Home > Give your views

Preventing misuse Terms of Use How to use Parent View

Give your views

Please register on Parent View

Email address
parent@hotmail.com

Confirm email address
parent@hotmail.com

Email addresses will be held securely, and will not be used for any purpose other than providing access to the questionnaire. Neither schools or Ofsted will have access to any email addresses. Please read our [Terms of use](#) before registering.

Please answer the questions below.

1: Are you a parent / carer? Yes No

2: How many schools do you / your child attend?

Check this box if you would like to receive emails from Ofsted

Register now

Quit survey X Your progress Register Search Questions Finish

Parent View will email you a confirmation message and PASSWORD. You will need to log into your email account to receive this password.

Parent View
Your child's school

Home Give your views Parent View results Link to us Contact Us

Return to the main Ofsted website

Preventing misuse Terms of Use How to use Parent View

Give your views

Please register on Parent View

Email address

Confirm email address

Email addresses will be held securely, and will not be used for any purpose other than providing access to the questionnaire. Neither schools or Ofsted will have access to any email addresses. Please read our [Terms of use](#) before registering.

Confirmation emails are generally sent out instantly. If you do not receive the confirmation, check your 'Spam' folder or 'Junk email' folder to make sure that our message has not been filtered.

Please answer the questions below.

1: Are you a parent / carer? Yes No

Check this box if you would like to receive emails from Ofsted

Register now

Quit survey X Your progress Register Search Questions Finish

Once logged in, please enter 'The Camden School for Girls' and 'Sandall Road'

*You do not need the full address

You are now able to complete your personal comments on the Parent View Survey.
Thank you once again for taking part in our survey.